

LM006 WiFi 802.11 b/g/n Adapter

Host Controller Interface (HCI) via USB Interface

Product	LM006
Part No	See Last Page
Revised	30/NOV/2018
Datasheet Version	1.1



Features

- WiFi 802.11 b/g/n
- Operates in 2.4 GHz Frequency bands
- Plug and Play (Linux, macOS X, Windows XP – 10 and Windows Compact Embedded 6/7 compatible)
- Up to 150Mbps Data Transfer Rate
- 1x1 SISO technology improves effective throughput and range over existing 802.11 b/g products
- 802.11e-compatible bursting and I standards
- BPSK, QPSK, 16 QAM and 64 QAM modulation schemes
- WEP, TKIP, and AES, WPA and WPA2 encryption schemes
- Fully-featured software utility for easy configuration and management
- Can be setup as an ad-hoc network for peer to peer communication
- Small convenient size
- RoHS, REACH and WEEE compliant
- See our website for this products certifications.

Overview

The LM006 USB adapter is a convenient plug & play solution that enables wireless communication in ad-hoc or infrastructure mode.

It is compatible with WiFi 802.11b, 802.11g or 802.11n compliant devices such as routers, access points or wireless adapters. Typically used to form a wireless LAN or for wireless access to the internet with a data transfer rates of up to 150 Mbps.

This cost effective adapter is designed for low power consumption, while maintaining excellent RF performance.



LM006 WiFi 802.11 b/g/n Adapter

Host Controller Interface (HCI) via USB Interface

Product LM006
Part No See Last Page

General Specification

Wireless

Wireless Standard	802.11 b/g/n
Module Type	Host Controller Interface (HCI)
OS Compatibility	Linux, macOS X, Windows XP – 10 and Window Embedded Compact 6/7
Security	WEP, TKIP, AES, WPA and WPA2
Network Architecture	Ad hoc mode (Peer-to-Peer) and Infrastructure mode

Hardware

Chipset	Realtek
Antenna	Onboard Chip Antenna
Interfaces	USB 2.0

RF Characteristics

Tx Output Power	(+/- 2dBm): 13dBm@11n, 17dBm@11b, 15dBm@11g
Rx Sensitivity	11Mbps -80dBm@8%, 54Mbps -70dBm@10%, 130Mbps -64dBm@10%
Range (in open space)	Up to 180m
Current Consumption	Transmit: average 305 mA Receive: average 190 mA
Data Transfer Rate	1,2,5.5,6,11,12,18,22,24,30,36,48,54,60,90,120 Mbps to a maximum of 150Mbps
Frequency	2.4GHz ISM Band
Modulation Scheme	BPSK/ QPSK/ 16-QAM/ 64-QAM
Spread Spectrum	IEEE 802.11b: DSSS (Direct Sequence Spread Spectrum) IEEE 802.11g/n: OFDM (Orthogonal Frequency Division Multiplexing)

Physical Characteristics

Operating Temperature	0°C to +50°C ambient temperature
Storage Temperature	-10°C to +70°C ambient temperature
Humidity	5% to 90% maximum (non-condensing)
Dimensions (L x W x H)	23.44mm x 14.40mm x 5.80mm
Weight	2.20g +/- 0.25g tolerance (27.78g in retail pack)
Certifications	See our website for this products certifications.
Compliance	RoHS, REACH and WEEE

LM006 WiFi 802.11 b/g/n Adapter

Host Controller Interface (HCI) via USB Interface

Product LM006
Part No See Last Page

Physical Dimensions

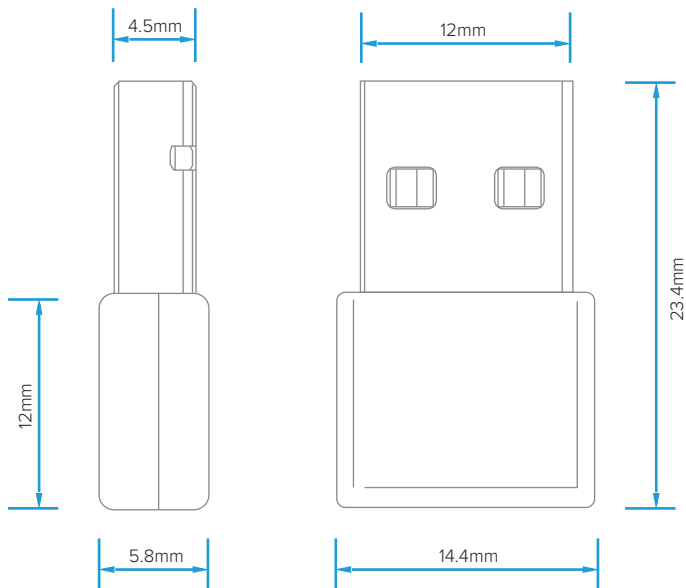
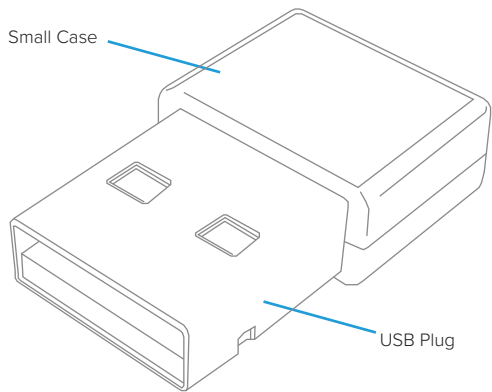



LM006 WiFi 802.11 b/g/n Adapter

Host Controller Interface (HCI) via USB Interface

Product LM006
Part No See Last Page

Datasheet Version Notes

v1.0	11 JAN 2018	Added version notes to datasheet.
v1.1	30 NOV2018	EOL Numbers added to Packaging Options.

LM006 WiFi 802.11 b/g/n Adapter
Host Controller Interface (HCI) via USB Interface

Product LM006
Part No See Below

LM006 Packaging Options



006-1009

Suggested Alternative
See LM007 or LM816

AO - Adapter Only

ADPT HCI 802.11n USB 8188 CUS IC-ANT AO



006-1008

Suggested Alternative
See LM007 or LM816

Sample (2x20)

ADPT HCI 802.11n USB 8188 CUS -40c IC-ANT SAMPLE (2x20)



006-1003

Suggested Alternative
See LM007 or LM816

AO - Adapter Only

ADPT HCI 802.11n USB 8188 CUS -40c IC-ANT AO



006-1004

Suggested Alternative
See LM007 or LM816

RP - Retail Pack

ADPT HCI 802.11n USB 8188 CUS -40c IC-ANT RP

- See our website to download any applicable Product Software, Manuals and Notes - <http://www.lm-technologies.com/downloads>